

SOL FINITION ENROBE POREUX



**SURFACES UTILES**  
**332.80 m<sup>2</sup>**

T.N. 31.14

T.N. 30.97

-0.04

-0.02

T.N. 30.76

T.N. 30.71

T.N. 30.63

T.N. 30.67

T.N. 30.57

T.N. 30.57

T.N. 30.64

T.N. 30.59

T.N. 30.60

1

T.N. 30.75

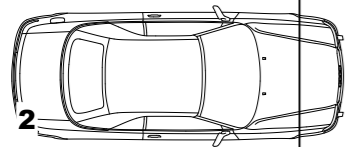

3

T.N. 30.73

4

5

6

A

A

C

B

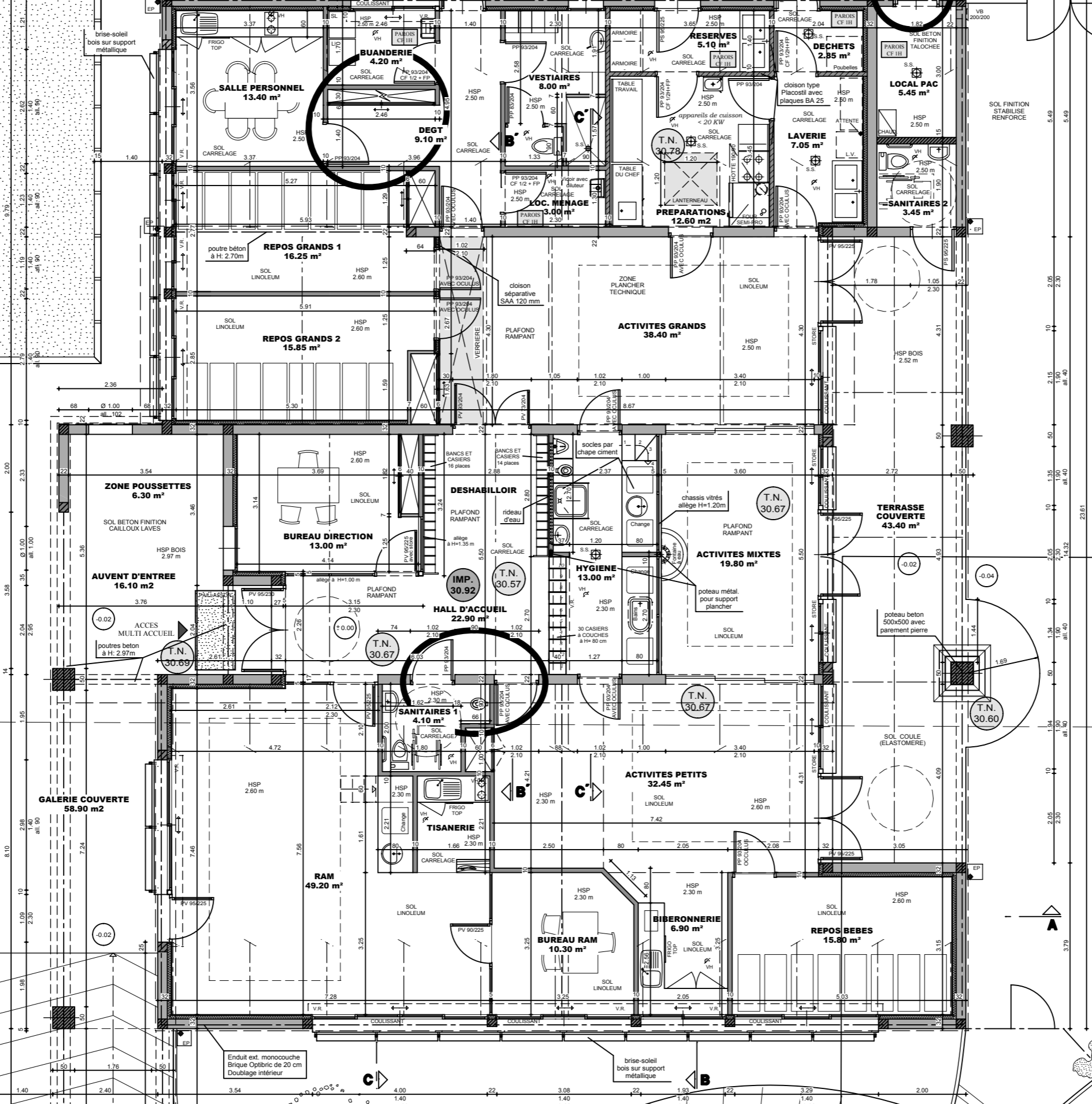
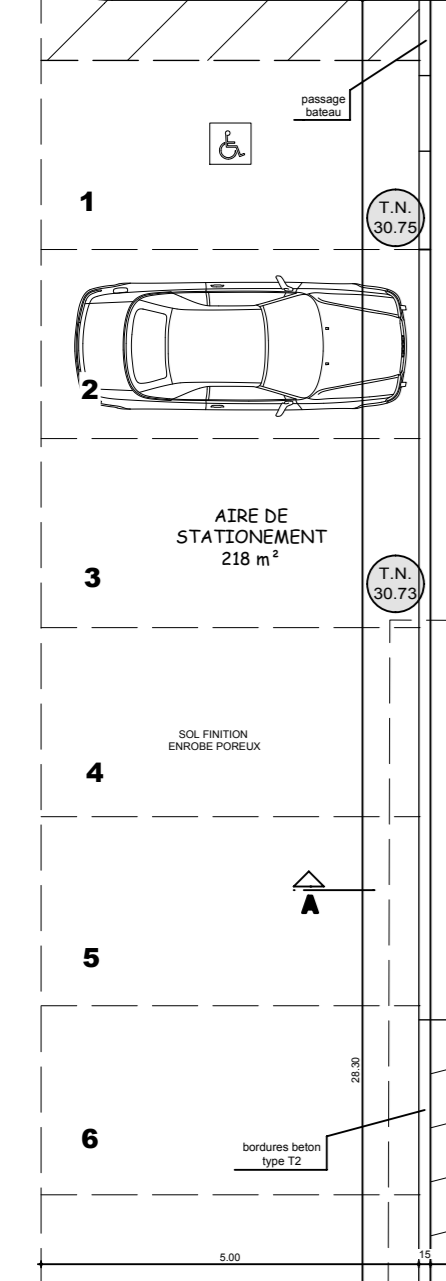
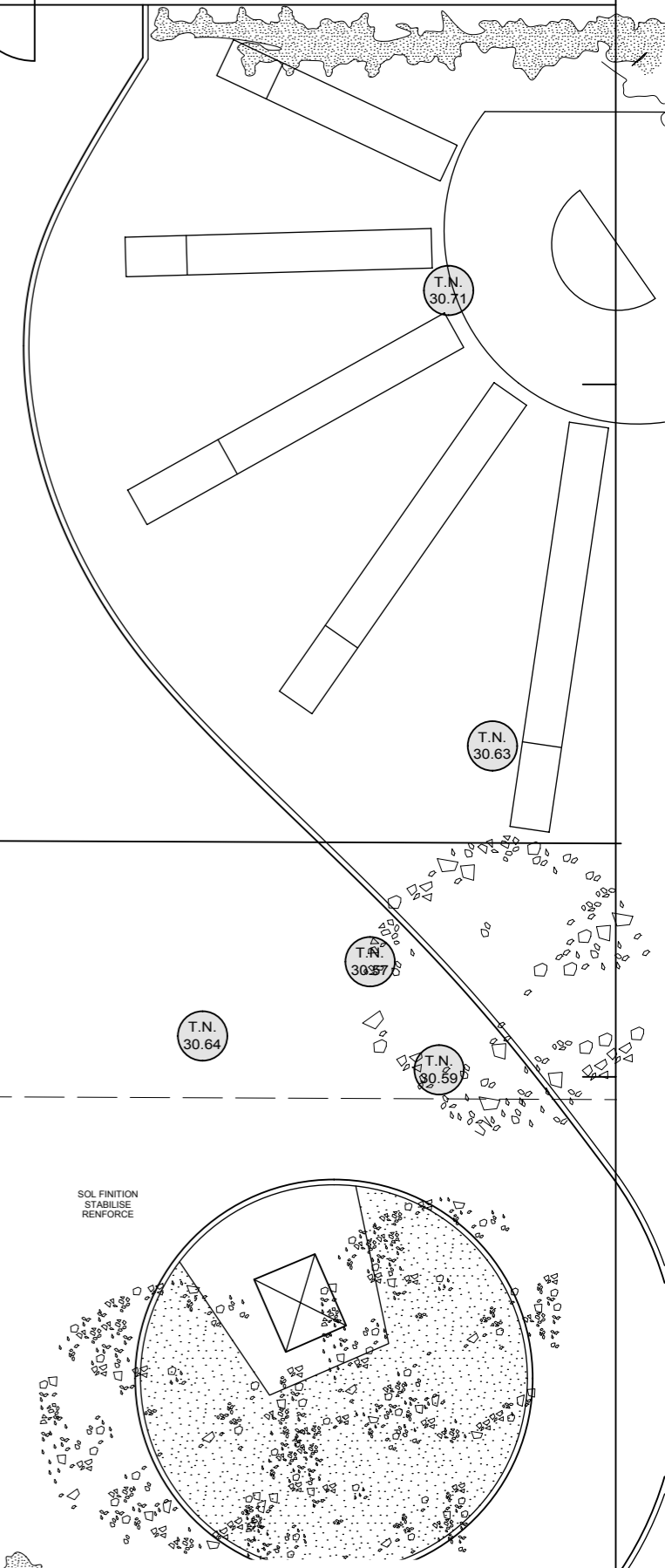
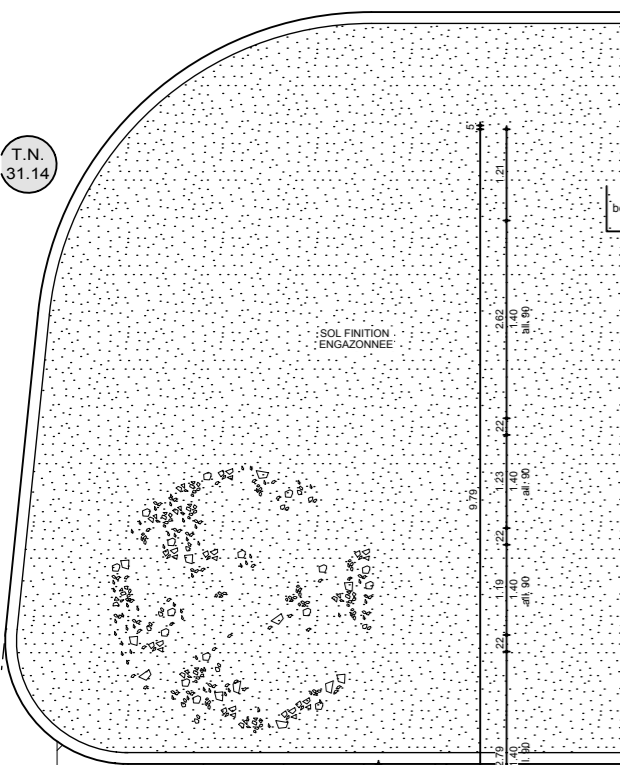

**PLAN - 1/100**